

WHAT TO DO IN CASE OF AN EMERGENCY?

A fire and/or power failure in a hotel has the potential to create panic. In order to minimize this type of response, it is important that proper procedures are followed.

POWER FAILURE:

In the event of a power failure, emergency generators will activate within 10 seconds and visibility will be restored to most areas.

IF YOU ARE IN A DARKENED AREA:

A Renaissance staff member will have a flashlight available for use until power is restored.

IF YOU ARE IN AN ELEVATOR:

Simply pick up the telephone receiver located in the elevator car, and you will be connected to the Renaissance Security Department.

INJURY:

Departments are equipped with a first-aid kit and are prepared to assist guests with minor injuries. The below procedure should be followed for more serious injuries or in the event of a medical emergency.

1. Call the Security Emergency Number at ext. 2900.
2. Give your location, and nature of the injury.
3. Wait where you are, trained security officers will respond immediately.

FIRE ALARM: The alarm system consists of an alarm horn, a recorded announcement, followed by a live voice announcement. The alarms will continue until the problem area is located by emergency personnel. Additional voice instructions may continue on a public address system.

Instructions are posted on the inside of each guestroom door.

R

RENAISSANCE®

ORLANDO AT SEAWORLD®

EMERGENCY RENAISSANCE CONTACTS

SECURITY EMERGENCY NUMBER

In-house ext. 2222
Outside: 407 248 7366

Dr. Phillips Hospital
9400 Turkey Lake Rd Orlando, FL
32819
407 238 4726

FIRE / AMBULANCE
407 656 6416

POISON CONTROL CENTER
18002221221

CVS PHARMACY
Westwood Blvd/ Central Florida Pkwy
2 minutes from The Renaissance Hotel
407 2384726

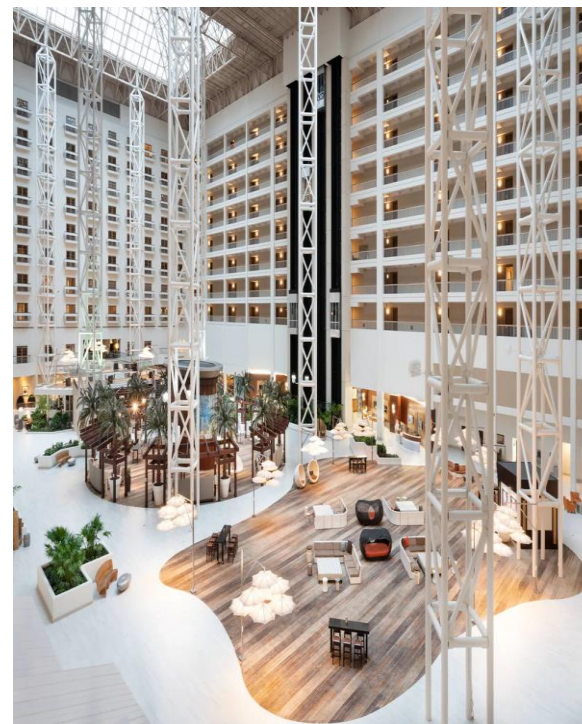

EMERGENCY GUIDE

JEROME PORTER
DIRECTOR OF SECURITY
T 407 248 7367

RENAISSANCE ORLANDO AT SEAWORLD
6677 SEA HARBOR DRIVE, ORLANDO,
FLORIDA 32821

RENHOTELS.COM

EMERGENCY HIGHLIGHTS

- Emergency evacuation plans are posted on the back of each guestroom door.
- In an evacuation, guests will be directed by trained staff. Information will be relayed through a resort wide PA system.
- All exit doors open in the direction of the major traffic pattern.
- The entire property is equipped and protected with automatic sprinkler and fire detection systems.
- Security staff members are First Aid & CPR trained.
- The property is connected to a back back-up generator and can operate up to 72-hours.
- Security staff members are on duty 24-hours a day, 7 days a week.
- Guestroom doors are equipped with door viewers, dead bolts, and swinging arm locks.
- Most exterior doors are locked by 11pm and unlocked by 5am.
- All stairwells and exits are equipped with emergency lighting.

Evacuation Assembly Areas

- 1 Oceans
- 2 North Lot
- 3 Valet Lot

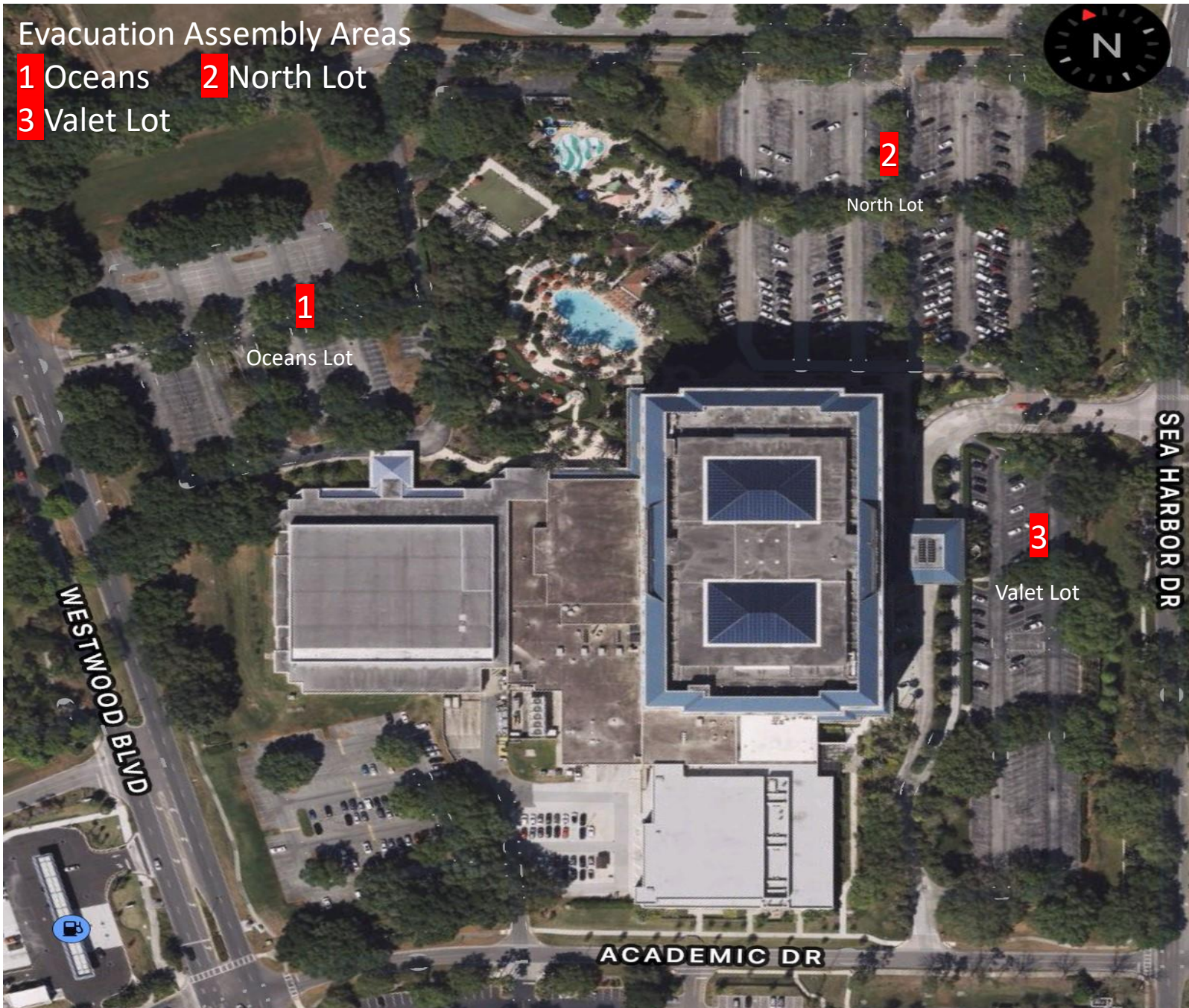

VENUE & MEETING ROOM EVACUATION ASSEMBLY AREAS

BALLROOM:

Exit any ballroom door, and proceed towards the nearest exit of the building via the glass doors.

Assembly Area: #1 Oceans Evacuation Location

Assembly Area: #2 North Evacuation Location

Assembly Area: #3 Valet Evacuation Location